



Boehringer Ingelheim Chemicals, Inc. Petersburg, Virginia

Boehringer Ingelheim Chemicals, Inc. (BI Chemicals) is a German company specializing in the manufacturing of chemicals used in the treatment of a variety of diseases including behavioral and muscular disorders and HIV, the virus that causes AIDS.

McKinney and Company provided schematic design through full construction documents for the Synthesis Support Facility consisting primarily of QC/QA Laboratory space, space for retained samples, general office and meeting space. The site for the Synthesis Building is a wooded site within the existing B.I. Chemicals property, and was incorporated into the overall campus master plan. Basic design services include the creation and validation of program information, meeting with user groups to determine specific needs, field review of existing facilities and utilities, creation of an existing and proposed equipment matrix, schematic floor plans, construction documents, specifications, final construction budget and schedule.

The design of the entire building is based on concepts allowing future east and west expansions. Access is limited to a security checkpoint at the main entrance. QC labs and the Developmental labs were combined into one compatible space with fixed support rooms such as glass storage, weights & measures and ICPMS. Support spaces are centrally located for easy access and to allow for the expansion. The walls of the labs are lined with windows to provide natural light and allow internal viewing into the lab space. Lab furniture was designed to maximize flexibility to accommodate changing sciences. Fume hoods with adjoining 6" utility walls are the only fixed casework. Overhead carriers provided above island benches at building columns are equipped with required electrical, special gas, water, vacuum, and point of use ventilation arms. All utilities to island benches are fed from overhead with accessible shut-off valves located just outside lab entry doors. Liquid waste lines are the only utility in the floor at every island bench.

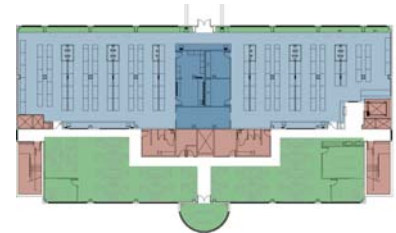

Contact:
Mr. Mark Waddell
B.I. Chemicals, Inc.
2820 North Normandy Dr.
Petersburg, Virginia 23805
(804) 504-8766